

# installation diagram

Step 1: Install the hanging board onto the ceiling first

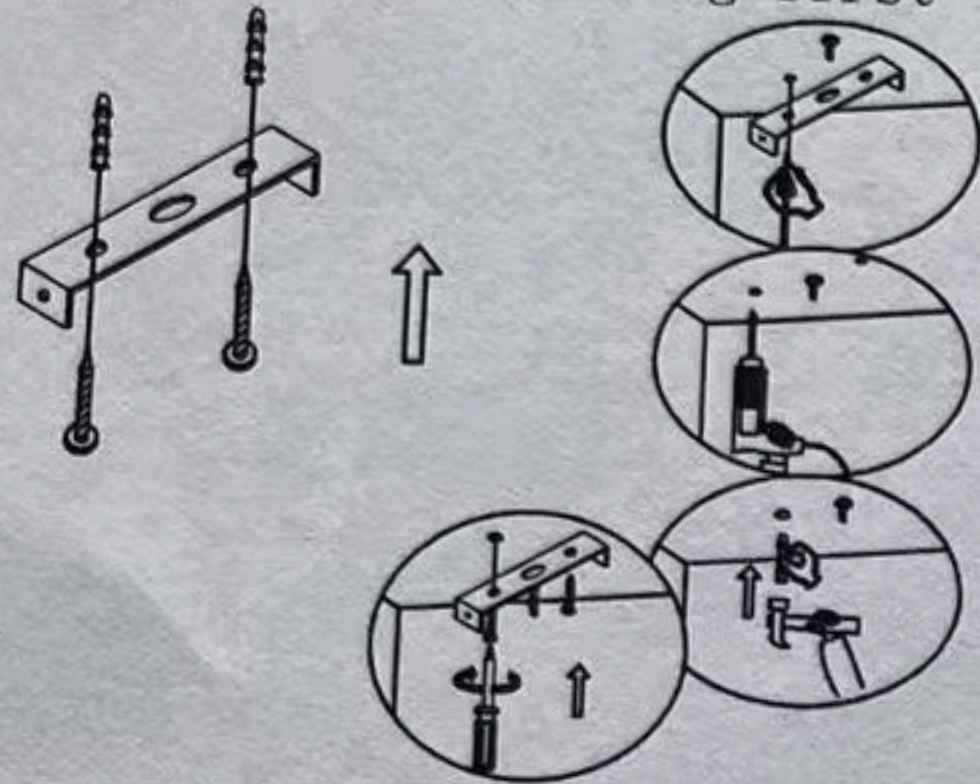

Installation diagram of fixed chandelier

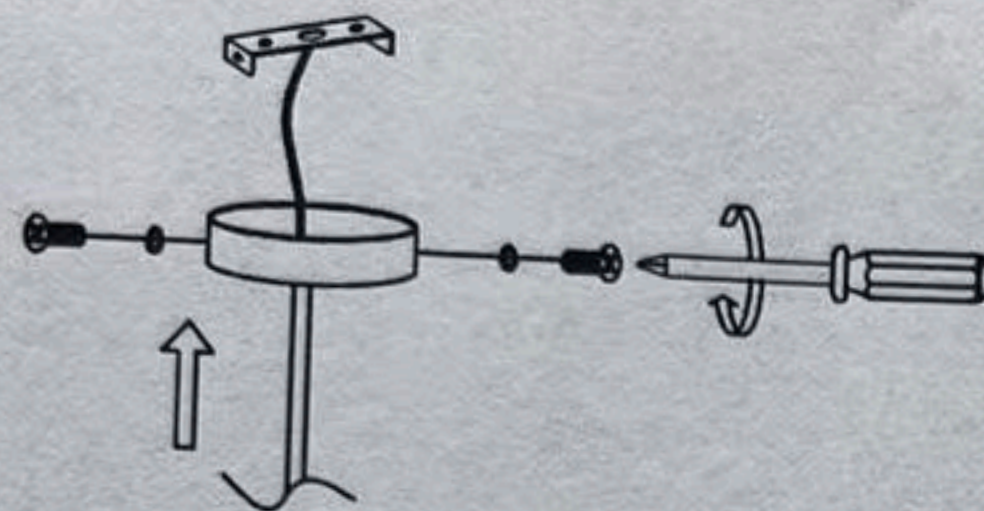

## Installation tools

Note:

1. Please use national standard screws to ensure the secure fastening of the tooth pattern lock. Self tapping screws/rubber plugs have limited load-bearing capacity and are only suitable for chandeliers.
2. The installation of heavy lighting fixtures requires the use of suitable specifications of iron expansion bolts and the installation of steel wire ropes to ensure the permanent lifting safety of the lamp body.



glove



screwdriver



test pencil



Self tapping screws



connecting terminal



wrench

## Warning:

1. Please wear gloves during the installation.
2. Do not install on ceiling which is damp or with wet limewater.
3. Cut off the electricity before installation in case of being shocked.
4. Make sure the connected bolt is tightly locked before getting through the electricity.



5. Do not cut off the electricity before washing or repairing, and use the scour without causticity.
6. Please cut off the electricity and wait until the bulb gets cooling before replacing the bulb in case of being burned.

# Installation instruction

Diagram: First try to light up and then install

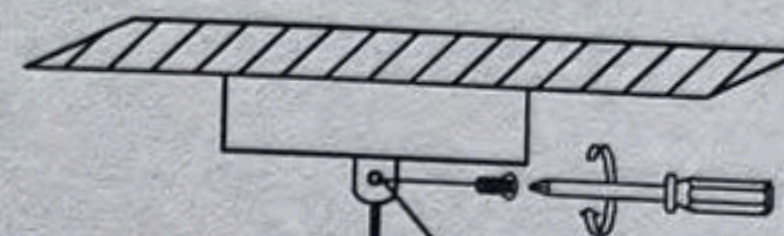

First, install the hanging board onto the ceiling, then adjust the chassis and wires to the appropriate height and tighten the safety screws

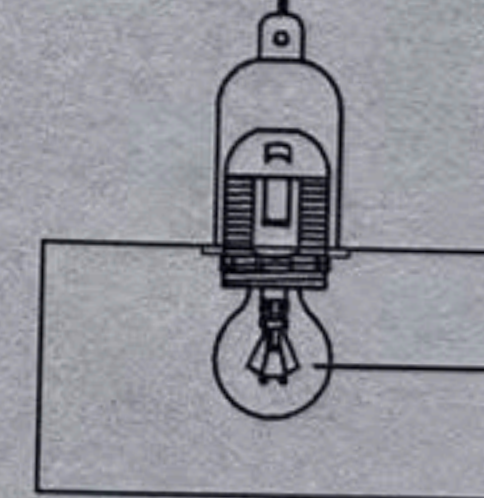

E27