

1. Please do not disassemble the product.
2. Water must not be used to wash the clipper, keep away from the dampness while operating.

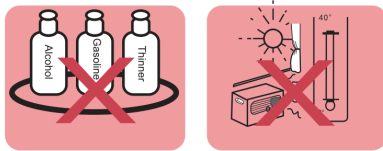

3. Only use a little wet cloth or neutral liquid soap to clean the product.
4. Never charge the product above 40°C heat source or below 0°C environment.

*Slight heating during the operating or charging is normal case
 *After the battery life expires, take off and throw the battery in safe manner into the designated recycling site. Never dump it randomly.

Cutter Cleaning and Maintenance

- Taper Blade Cleaning
- Taper Blade Maintenance

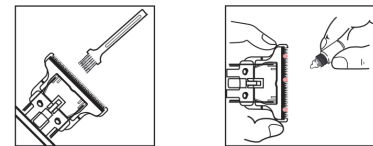

1. Please do not disassemble the product.
2. Water must not be used to wash the clipper, keep away from the dampness while operating.

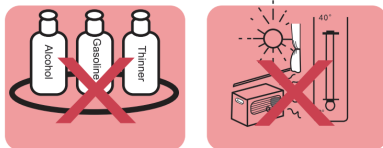

3. Only use a little wet cloth or neutral liquid soap to clean the product.
4. Never charge the product above 40°C heat source or below 0°C environment.

*Slight heating during the operating or charging is normal case
 *After the battery life expires, take off and throw the battery in safe manner into the designated recycling site. Never dump it randomly.

Cutter Cleaning and Maintenance

- Taper Blade Cleaning
- Taper Blade Maintenance

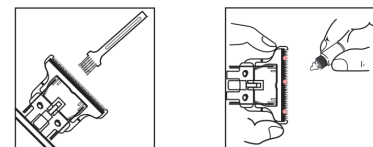

1. Please do not disassemble the product.
2. Water must not be used to wash the clipper, keep away from the dampness while operating.

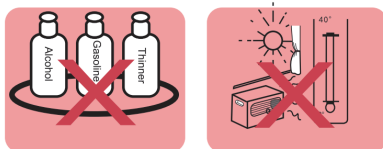

3. Only use a little wet cloth or neutral liquid soap to clean the product.
4. Never charge the product above 40°C heat source or below 0°C environment.

*Slight heating during the operating or charging is normal case
 *After the battery life expires, take off and throw the battery in safe manner into the designated recycling site. Never dump it randomly.

Cutter Cleaning and Maintenance

- Taper Blade Cleaning
- Taper Blade Maintenance

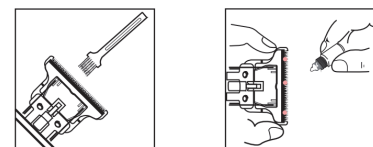

Attention

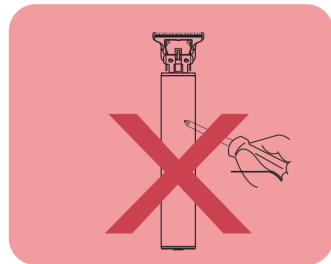

Do not take apart this product



Do not wash this product in water

Attention

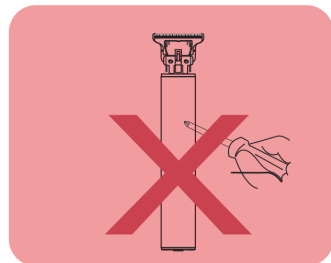

Do not take apart this product



Do not wash this product in water

Attention

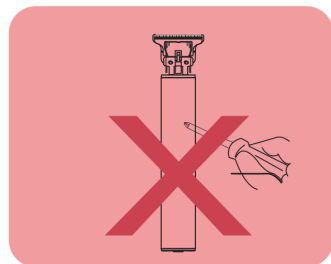

Do not take apart this product



Do not wash this product in water

Professional Clipper
 DESIGNED FOR THE PROFESSIONAL

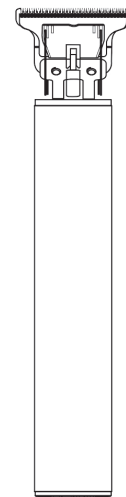

Operating Manual

Components

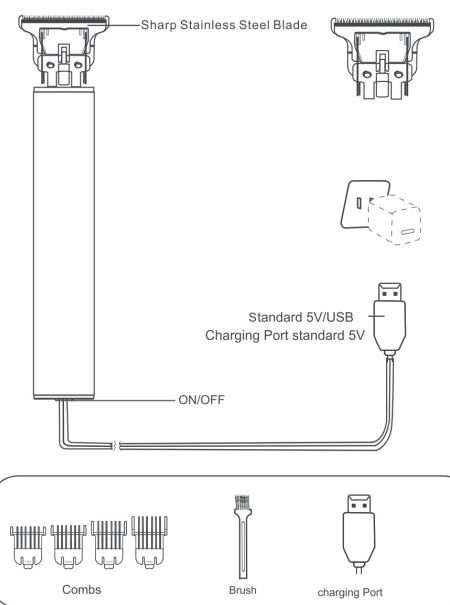

Parameters

Professional Hair Clipper	Motor	Operating
	Battery	Battery type: 1200mAh/800mAh Charge time: 3h Operating time: 90mins-180mins
Charge	USB connect with adapter 5V-1000mA voltage: 3V	Power: 5W

Use the Rechargeable Mode



1. Insert the charger into the tail of clipper, connect to the power to start charging.
2. The liquid crystal indicator lights up, indicating that it starts charging.

Note: when the power is switched on after charging, the indicator lights up to indicate that the charging head is reversed or drawn to be replaced immediately.

Clear up the blade with cleaning brush. Before or after use, maintain the blade by dripping some oil on the red point places like the left picture.

Fixed-length Function

A: Features (1, 2, 3mm) three lengths adjustment to control hair length.

1. To determine the length of haircut
2. To select the appropriate limit comb

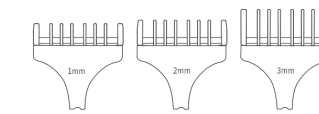

Mount the limit comb:

1. Align the limit comb with the blade edge
 2. Slightly forward push to mount it.
- Disassemble the limit comb:
Just pull hard the limit comb



Clear up the blade with cleaning brush. Before or after use, maintain the blade by dripping some oil on the red point places like the left picture.

Fixed-length Function

A: Features (1, 2, 3mm) three lengths adjustment to control hair length.

1. To determine the length of haircut
2. To select the appropriate limit comb

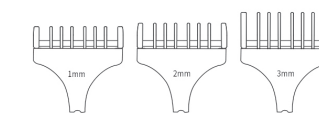

Mount the limit comb:

1. Align the limit comb with the blade edge
 2. Slightly forward push to mount it.
- Disassemble the limit comb:
Just pull hard the limit comb



Clear up the blade with cleaning brush. Before or after use, maintain the blade by dripping some oil on the red point places like the left picture.

Fixed-length Function

A: Features (1, 2, 3mm) three lengths adjustment to control hair length.

1. To determine the length of haircut
2. To select the appropriate limit comb

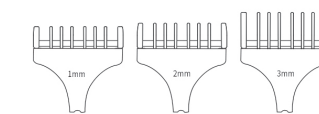

Mount the limit comb:

1. Align the limit comb with the blade edge
 2. Slightly forward push to mount it.
- Disassemble the limit comb:
Just pull hard the limit comb



Professional Clipper
 DESIGNED FOR THE PROFESSIONAL

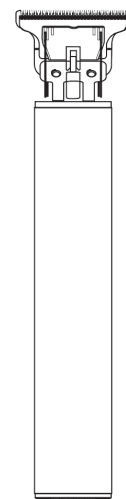

Operating Manual

Components

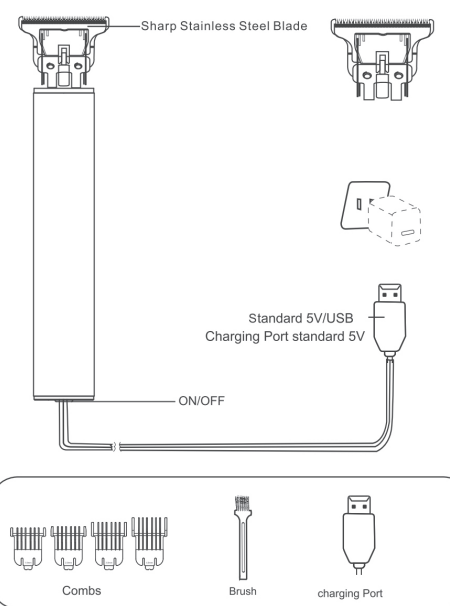

Parameters

Professional Hair Clipper	Motor	Operating
	Battery	Battery type: 1200mAh/800mAh Charge time: 3h Operating time: 90mins-180mins
Charge	USB connect with adapter 5V-1000mA voltage: 3V	Power: 5W

Use the Rechargeable Mode



1. Insert the charger into the tail of clipper, connect to the power to start charging.
2. The liquid crystal indicator lights up, indicating that it starts charging.

Note: when the power is switched on after charging, the indicator lights up to indicate that the charging head is reversed or drawn to be replaced immediately.

Clear up the blade with cleaning brush. Before or after use, maintain the blade by dripping some oil on the red point places like the left picture.

Fixed-length Function

A: Features (1, 2, 3mm) three lengths adjustment to control hair length.

1. To determine the length of haircut
2. To select the appropriate limit comb

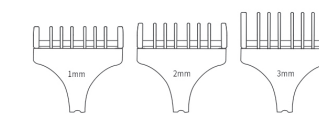

Mount the limit comb:

1. Align the limit comb with the blade edge
 2. Slightly forward push to mount it.
- Disassemble the limit comb:
Just pull hard the limit comb



Professional Clipper
 DESIGNED FOR THE PROFESSIONAL



Operating Manual

Components

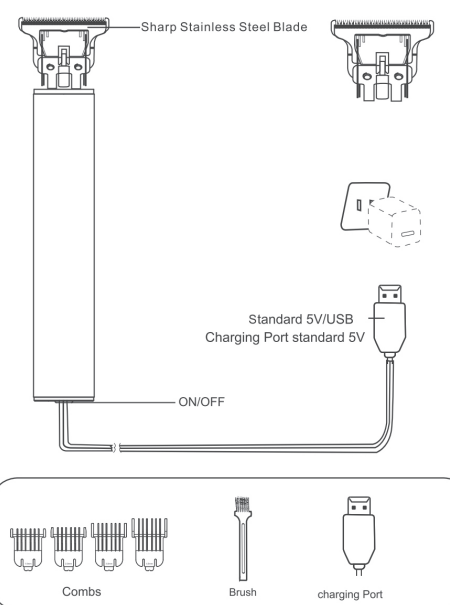

Parameters

Professional Hair Clipper	Motor	Operating
	Battery	Battery type: 1200mAh/800mAh Charge time: 3h Operating time: 90mins-180mins
Charge	USB connect with adapter 5V-1000mA voltage: 3V	Power: 5W

Use the Rechargeable Mode



1. Insert the charger into the tail of clipper, connect to the power to start charging.
2. The liquid crystal indicator lights up, indicating that it starts charging.

Note: when the power is switched on after charging, the indicator lights up to indicate that the charging head is reversed or drawn to be replaced immediately.