

Product manual

Input voltage: DC 9-30V/AC85-256V

Maximum power: 660W/3A

Wireless standard: Wi Fi 2.4GHz b/g/n+Bluetooth

RF frequency: 280-915MHz

Product size: 57 * 47 * 25mm

Control method: jog

Wireless remote control distance:> 50m

Support wireless encoding formats: learning code
fixed code, rolling code, etc

APP Download

1. You can also search for "Graffiti Intelligence" or "Smart Life" on the Apple Store and major app markets. Download the app by scanning the following QR code.



2. If there is a prompt for permission request during the installation process, please select 'Allow'.
3. Register an account and log in to the Graffiti Smart APP (Smart Life APP).
4. Please follow the prompts to connect the wires correctly, and live installation is strictly prohibited.
5. After completing the wiring, turn on the power and the device will default to off for incoming calls. You can change the settings on or off for incoming calls in the app.

Device Installation:

Power on: Ensure that the device is in a power-off state before starting, and connect the device power supply

Reset device:

After the device is powered on, the network indicator light on the device will flash twice per second. Please skip this step.

1. Power on the device.

Press and hold the reset button for about 6 seconds until the network indicator light flashes rapidly (2 flashes per second).

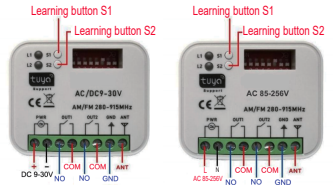

Learning button S1

Learning button S2

Learning button S1

Learning button S2

Learning button S1

Learning button S2

Learning button S1

Learning button S2

Learning button S1

Learning button S2

Learning button S1

Learning button S2

Learning button S1

Learning button S2

Add Device :

1. Open the Graffiti Smart APP or Smart Life APP,
2. click" + "add device
3. wait for a few seconds, and when prompted to find the device, select "Add"
4. Select your 2.4G wifi network and enter the password
5. After successful addition, name your device to complete the setup



6. After successful addition, name your device to complete the setup

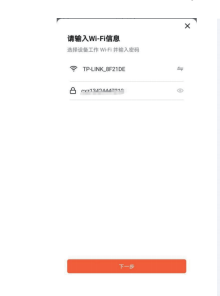

Using the Device

1. When the network indicator blinks steadily, the device is ready for remote control
2. On the app's home screen, tap the switch icon to turn the device on or off. The app will display the current status in real-time.
3. For Bluetooth control, the switch will automatically connect when the device is disconnected from wifi



APP Function settings

1.Click the device name to enter function settings.from wifi

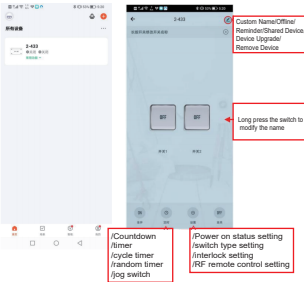

2.Turn the device on/off or manage multiple devices simultaneously



Note:Press the switch 1 /switch 2 button



Note: First click the "Timer" button, then select the corresponding "Switch" button for settings. Countdown timing, loop timing, random timing, and jog switch timing can be set.

3.Switch type setting



Note: First click the "Settings" button, and then select the corresponding "Settings" button. Power on status setting: Power off: refers to the device being powered off when the power is restored.

Power on: This means that the device is powered on again.

Power off memory: that is, the device remains in its pre power off state when the power is restored,

Switch type setting: Shift switch - Flip switch / Off shift switch - status synchronization Button type switch.

Interlock setting: Only one device is powered on, and the other devices must be in a power-off state,

RF remote control settings: omitted

1.Pairing:

1.OUT1 channel coding: Press the learning button S1 once. Press the remote control repeatedly, and the indicator light will flash, indicating that it is on Success in learning.

2.OUT2 channel coding: Press the learning button 2 once. Press the remote control frequently, and the indicator light will flash, indicating successful learning of the OUT2 channel.

2.Code clearing

1.OUT1 channel clear code: Long press the learning button S1 or button S2, any one key. The indicator light flashes, indicating successful code clearing of OUT1 channel.

2.OUT2 channel clear code: Long press the learning button S1 or button S2, any one key. The indicator light flashes, indicating successful code clearing of OUT2 channel.

2.Reset

Press and hold the reset button for about 6 seconds, the indicator light will flash rapidly (flashing twice per second), and the device will enter the re distribution network.

Pre-Use Checklist

- 1.Ensure your phone or tablet is connected to a 2.4GHz wifi network (5GHZ wifi is not upported at the mament)
- 2.Enable Bluetooth on your phone
- 3.For Android devices,ensure the system version is at least 4.0
- 4.For Appie devices,ensure access to the App store
- 5.If your wireless router has MAC address filtering enabled

